

Administrative Updates

May 6, 2025



Community Engagement Highlights

www.slc.gov/feedback/

Regularly updated with highlighted ways to engage with the City.

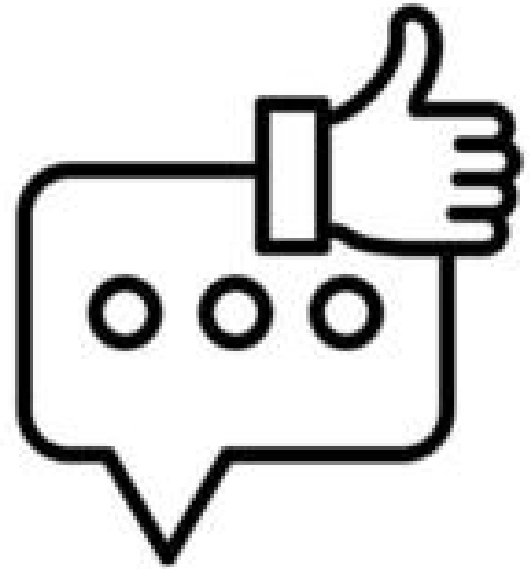

Engineering Update

2100 South (D7)

- First pave of the season this week
- Wednesday and Thursday night between 7pm-7am

1300 East Reconstruction (D6)

- 1-80 and 2700 South
- Completed by fall 2025

300 North Reconstruction (D2, 3)

- 300 West to 1000 West
- In the final phase! Early August completion



Transportation Projects – Safer Streets

Capitol Hill Traffic Calming (D3)

- 600 N & 200 W under construction

Kensington Neighborhood Byway (D5, 6)

- Construction underway through summer 2025

Poplar Grove Neighborhood Byway (D2)

- Design finalization

Sugar House Safe Side Streets (D7)

- Construction ongoing this Spring

Livable Streets (Citywide)

- Zones 2/4 under construction

Westminster to Sunnyside Neighborhood Byway (D6)

- Initial engagement closed

Westpointe & Jordan Meadows Neighborhood Byway (D1)

- Construction coming in June

2025 Lane Reconfigurations (Citywide)

- 2100 S. Sunnyside Ave, and 1300 East

California Ave Pedestrian Study (D2)

- Design work underway

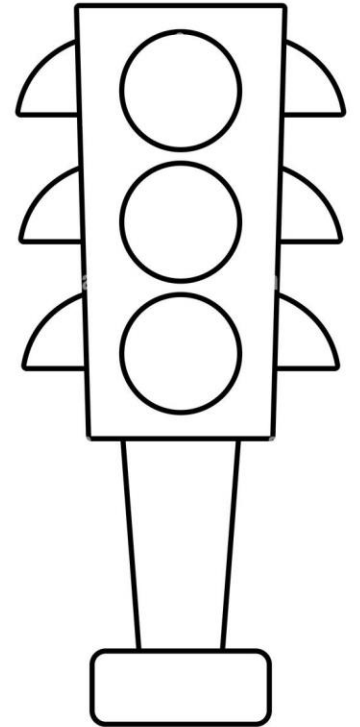

Transportation Projects Continued

300 West Bikeway (D4, 5)

- Protected bike lanes - Starts June

400 South Safety Improvements (D2)

- Complete

Ballpark Station Crosswalks (D5)

- 2 new signalized crossings almost complete

Bus Stop Improvements (Citywide)

- Construction has begun

400 South Viaduct Trail (D2, 4)

- Shared use path – contractor secured

Sunnyside Ave Safety Improvements (D6)

- On hold as new legislation is worked through



Transportation Projects Continued

1300 East / University District Circulation Study (D4, 6)

- Multimodal access and circulation near U of U
- Extended timeline

600/700 North Reconstruction (D1)

- Focus on 1200-1500 West and 700 North/Redwood Road
- No detours are in place for this work

West-East Connections (Citywide)

- Community Advisory Board Selected
- Open House May 21 5:30-7pm – Edison Elementary
- Online also available

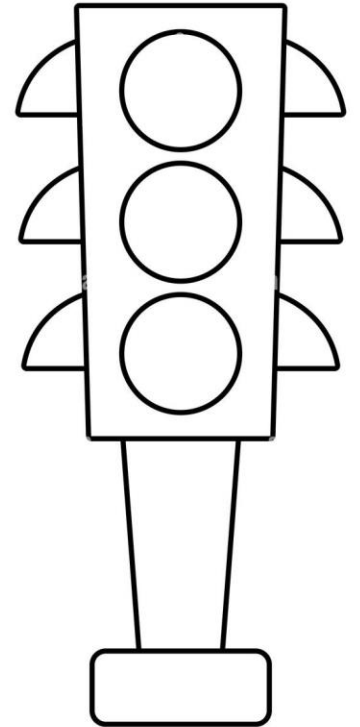

Public Lands Projects

SLC Foothills Trailheads Improvements (D3, 6)

- Grand opening – May 28, 9AM at the Bonneville Boulevard Trailhead

Fairmont Park Improvements (D7)

- Public Survey complete

University of Utah Baseball Stadium & Sunnyside Park (D6)

- 3 conceptual sites are under development

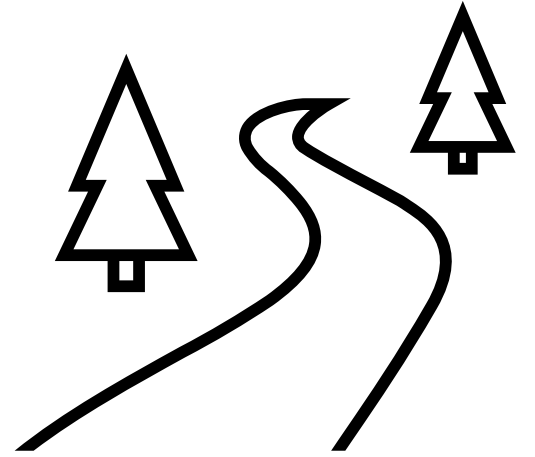

Planning – Zoning Codes

Multi-family Merger: RMF-35 / RMF-45 (Citywide)

- Planning Commission May 14

Separating Residential from High-Impact Uses (D1,2,3)

- Recommended for adoption

Adaptive Reuse Incentive Update (Citywide)

- Recommended for adoption

Fence Height Amendment (Citywide)

- Public Comment closes May 8

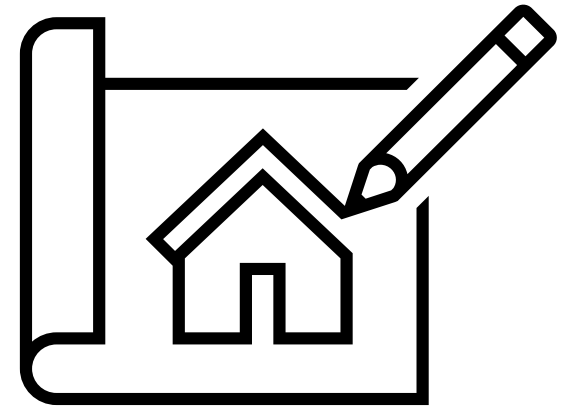

Planning – Community Plans

Avenues & Capitol Hill Community Plan Updates (D3)

- Engagement beginning June 2025

Rio Grande District Plan Update (D2)

- Public comment closed May 1

Northwest Community Plan (D1, 2)

- Public engagement scheduled this Spring

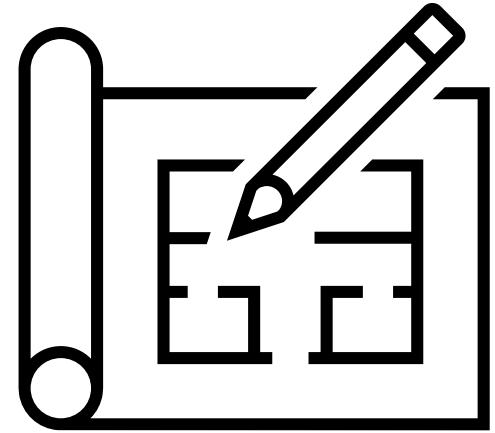

Mayor's Office

Love Your Block

- 10/16 Projects complete
- Remaining wrapped by May 31
- Now accepting new applications for our next cycle! - also by May 31

SLC Corps

- Supported Public Lands' Green Day 2025 event

Community Office Hours at Summer Community Events!

- Posting soon



Homelessness Update

Shelters: 801-990-9999

Additional System Information:

Salt Lake Valley Coalition to
End Homelessness (SLVCEH)
[endutahhomelessness.org/
salt-lake-valley](https://endutahhomelessness.org/salt-lake-valley)

Utah Office of Homeless
Services (OHS)
[jobs.utah.gov/homelessness/
index.html](https://jobs.utah.gov/homelessness/index.html)

Homeless Resource Center Utilization

April 21-25: **92.5%*** (winter beds ramp down)

<https://endutahhomelessness.org/daily-bed-availability/>

Encampment Impact Mitigation/ Rapid Intervention

- EIM- None
- RIT- Fife Preserve, Backman to Day Riverside, 1700 E & 2300 S, various constituent locations

Resource Fair:

Friday May 9th @ Library Square

Homelessness Update

Shelters: 801-990-9999

Additional System Information:

Salt Lake Valley Coalition to
End Homelessness (SLVCEH)
[endutahhomelessness.org/
salt-lake-valley](http://endutahhomelessness.org/salt-lake-valley)

Utah Office of Homeless
Services (OHS)
[jobs.utah.gov/homelessness/
index.html](http://jobs.utah.gov/homelessness/index.html)

Summer Emergency Shelter Capacity

	<u>Year-round</u>	<u>Summer</u>
King HRC	200	50
Miller HRC	200	50
Atkinson HRC	300	---
Youth RC	30	20
West Valley	---	200
Ville 1990 (N Temple)	---	198
<u>St Vincent (overnight)</u>	---	<u>65</u>
Total: 1313 =	730	583
Family HRC	300	---
FINCH*	72 rooms	
FINCH will open in May with ~ 6 families/week moving in		